

Haunting Lace Scene

Dive into a world of spooky scenes and elegant lace! This tiny world is sure to please, and takes only seconds to create. Follow these step-by-step instructions to create a festive new decor piece (or two!) for your haunted home.

Supplies

To craft your freestanding lace Halloween scene, you will need:

[Haunting Scene \(Lace\)](#) embroidery designs
30-50 wt. 100% cotton thread
Stand template ([download the PDF here](#))

Printer

Cardstock to match the color of your lace

Scissors

Optional: Take it a step further with a



TUTORIAL

Steps To Complete



Begin by stitching your piece of freestanding lace onto heavy duty water-soluble stabilizer using 100% cotton thread (30-50 wt.). Stitch one lace piece per hooping to prevent shifting.

Rinse and dry the piece completely ([here's more on stitching freestanding lace](#)).

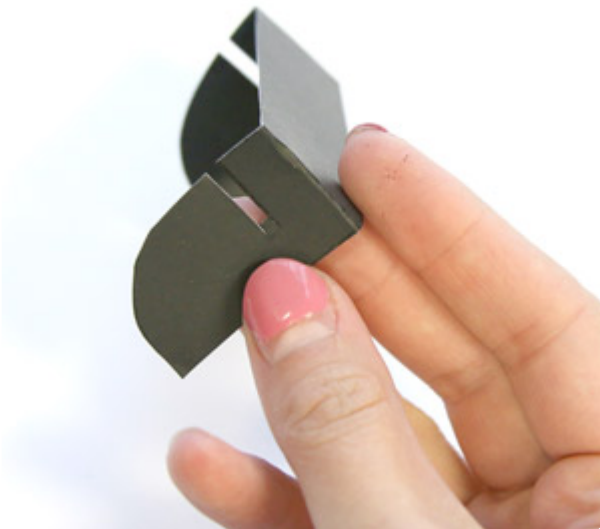

Grab your template and print it directly onto the color cardstock you intend to use, or you can print on regular white paper, then cut and trace onto your desired cardstock. Make sure to follow the "cut" and "fold" lines carefully.



Place each lace piece in the joints of the stand.



Each piece of lace will fit into its own stand, so choose one, or mingle your lace with other pieces to make a scene.



Arrange and decorate as desired, for a haunting little town!



Take the scene a step further by adding the scene to the inside or outside of a lamp shade!

To achieve this look, you will need:



A lampshade where the bulb sits towards the top half of the shade. I used a lampshade 10 inches in diameter, which allowed for the placement of 8 lace pieces without overlapping the lace.

Mod Podge, hot glue, or any non-flammable permanent adhesive.

A paint brush if you are using Mod Podge
Clothespins



Start by joining your lace scene together:

Choose top and bobbin threads to match your lace designs, then use a zigzag stitch to connect your lace scene pieces together.



When you're done sewing you should have a spooky village row.



Apply a generous amount of Mod Podge to the back of your lace pieces using a pain brush. The great thing about this product is that it dries clear -- so don't worry about it showing through on the front side of the lace.



Attach the scene around the edge of a lamp shade using hot glue or Mod Podge, holding each panel in place with clips as it dries.

TIP: It's important to press the lace down as the glue is drying, so I found setting the shade on it's side (propped so it doesn't roll around), with a hand towel set on top of the lace, is the best way to ensure the lace adheres to the shade.

Let this dry overnight to ensure a strong hold before re-installing it on your lamp.

If you want you can place your lace on the inside of the shade to create a surprise scene when the light is turned on.



Attach the lace to the inside of the lamp by carefully hot gluing your scene around the bottom edge. Make sure that the lace pieces aren't falling forward into the bulb and are completely adhered to the shade.

NOTE: Choose a lampshade with an open radius and a high-sitting bulb. We recommend using no higher than 40 watt incandescent light, or any wattage of florescent or LED, to avoid a fire hazard.



When the light is on, a haunting scene appears from inside the lamp! A sweet surprise for some festive decor.



No matter how you use your lace scene, these simple pieces are sure to stir up some decor envy!